



KENSINGTON AND
CHELSEA QUALITY
REVIEW PANEL

YEAR TO
31 DECEMBER 2022

ANNUAL
REPORT

IN PARTNERSHIP WITH

Frame Projects
Unit 15 Waterside
44-48 Wharf Road
London N1 7UX
020 8164 9980
office@frame-projects.co.uk
frame-projects.co.uk



THE ROYAL BOROUGH OF
KENSINGTON
AND CHELSEA



INTRODUCTION

The Kensington and Chelsea Quality Review Panel was set up in 2020 by Frame Projects on behalf of the Royal Borough of Kensington and Chelsea (RBKC). It is co-chaired by Catherine Burd and includes 26 professional experts, selected through an open recruitment process in collaboration with RBKC officers, and two local resident experts.

Terms of Reference, available via the Council's web site, sets out the role and remit of the panel, and the way in which it supports the planning process. Schemes requiring advice are identified by planning officers and referred to the panel for a review. Officers provide a briefing on planning context and key issues, both in writing for the meeting agendas, and in person at the panel meeting. Advice given by the panel is recorded in a report, to assist with continuing pre-application negotiations, or advise the planning committee on submitted schemes.

The Kensington and Chelsea Quality Review Panel advised on 13 different schemes in the year from January to December 2022. Seven of these schemes was reviewed on more than one occasion. First reviews usually take place at a stage when a client and design team have decided their preferred option for development of a site, and have sufficient drawings, models, etc. for a comprehensive discussion. There will often be a second pre-application review to provide advice on more detailed design matters, prior to planning submission.

Cover image and page image: Natural History Museum © Feilden Fowles, J & L Gibbons

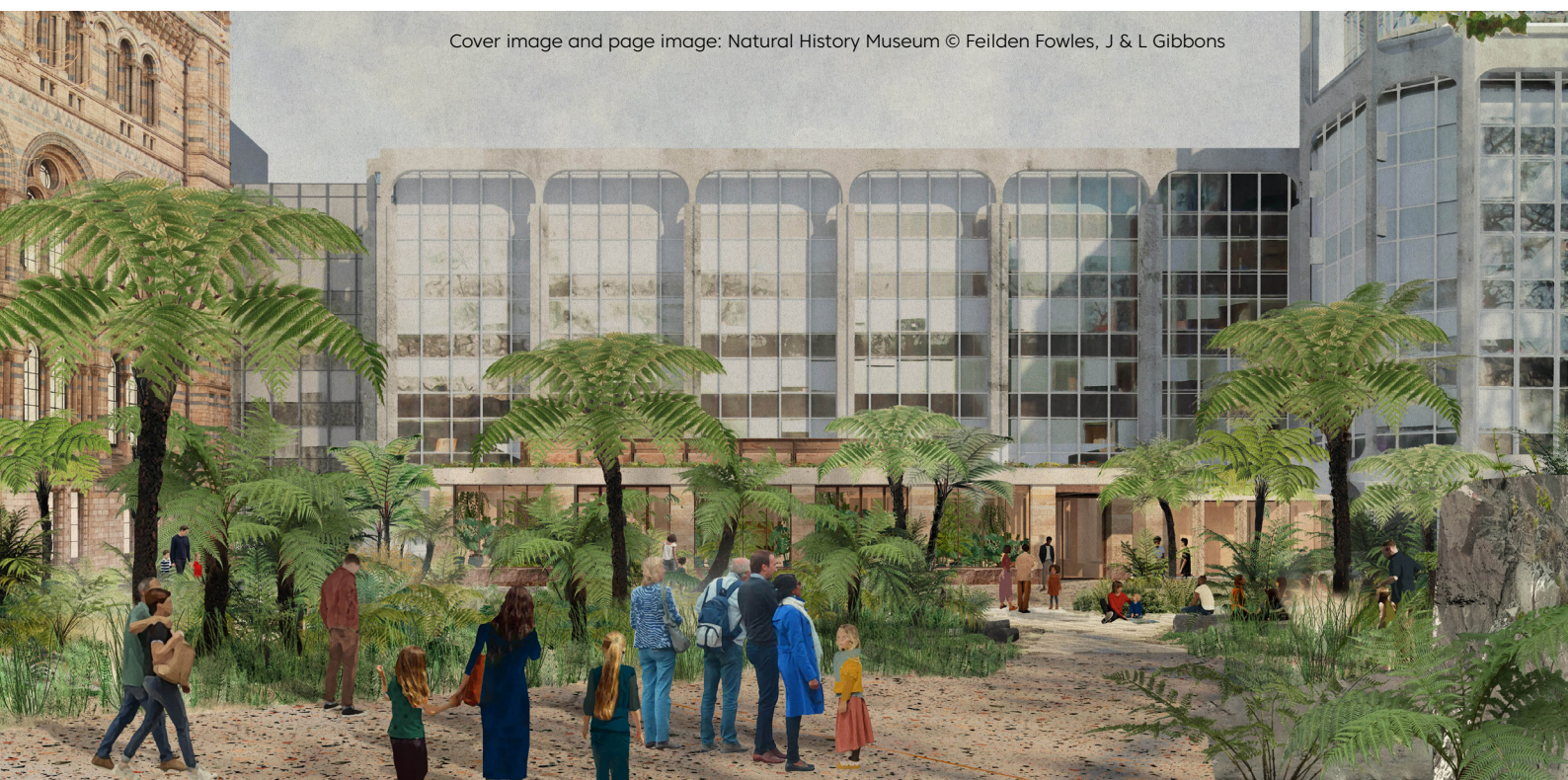

Quantitative data was gathered from reviews that took place from 1 January to 31 December 2022.

PANEL

Authority	Royal Borough of Kensington and Chelsea
Review Panel name	Royal Borough of Kensington and Chelsea Quality Review Panel
Panel management	Externally managed, Frame Projects
Contact name for panel	Bonnie Russell, Frame Projects
Contact email address	Bonnie@frame-projects.co.uk
Report produced by	Cindy Reriti, Frame Projects

Image: The Kensington Building © Pilbrow and Partners, Hufton + Crow



REVIEW TOTALS

Number of first reviews

6

Number of site visits
(virtual)

1

Formal reviews
(chair plus four panel member)

9

Number of follow up
reviews

7

Number of site visits
(in person)

7

Chair's reviews
(chair plus one panel member)

4

PANEL COMPOSITION

PANEL MEMBERS USED THIS YEAR

No. of different panel members used

21

Male panel members

48%

Female panel members

52%

Diverse ethnic backgrounds

14%

PANEL EXPERTISE USED

Architecture

11

Landscape / public realm

5

Heritage / townscape

16

Local resident expert

2

Urban design / town planning

3

Transport planning

2

Sustainability

6

Inclusive design

2

PROPOSALS REVIEWED

APPLICANT TYPE

Private developer

8

Local authority

5

STAGE OF PROPOSAL

Pre application

10

Planning application
submitted

0

Amendment to
approved application

0

TYPE OF PROPOSAL

Masterplan

1

Mixed use

6

Policy or strategic
document

3

Commercial

3

EMERGING ISSUES AND NEXT STEPS

There have been a wide range of schemes reviewed this year including a placemaking framework, one of the borough's own housing schemes, commercial buildings, a hotel, and a large masterplan. Three reviews were held to discuss the Earl's Court site allocation and placemaking framework. This allowed the panel to support Kensington and Chelsea planning officers in establishing strategic design principles for a site with potential to deliver a significant number of new homes and facilities for the borough.

Frame Projects has used the majority of the panel membership throughout 2022. However, a need to improve on the proportion of panel members attending reviews from a diverse ethnic background was identified. To address this Frame Projects worked with council officers to refresh panel membership in early 2023. This also provided an opportunity to improve increase sustainability expertise and to bring fresh perspectives. Nine new panel members were appointed and the percentage of panel members from a diverse ethnic background has increased from 14.29 to 21 per cent. Female membership has increased from 52 to 54 per cent. 36 per cent of the panel members now have either professional or personal knowledge of the borough.

Image: Vardo Restaurant © Nex James Brittain

